

DH-24

WATERPROOF CONNECTOR

INTRODUCTION

DH24 serials waterproof connector includes power, signal, USB and optical fiber ,which is with alloy metal shell, unique design and rotary locking type to meet different industrial requirement, widely be used in LED display screen, industrial equipment, stage lighting equipment and other field.



color identification



screw type locking

- 1:Support 24mm mounting dimensions
- 2: With military standard screw type locking
- 3: With different colors for Power,USB,optical fiber and RJ45 to be easily separated
- 4:With alloy protective materials to reduce external electromagnetism and signal Radio frequency interference
- 5:metal and silica gel cover are optional to be used in different environment
- 6:USB connector with 0.5m cable length, and also be customized
- 7:Waterproof level: IP65/IP67



Coupler



silica gel dust cover



sliding preventing design

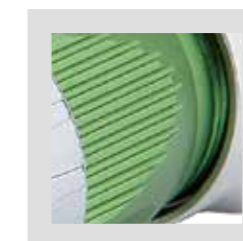

colors optional

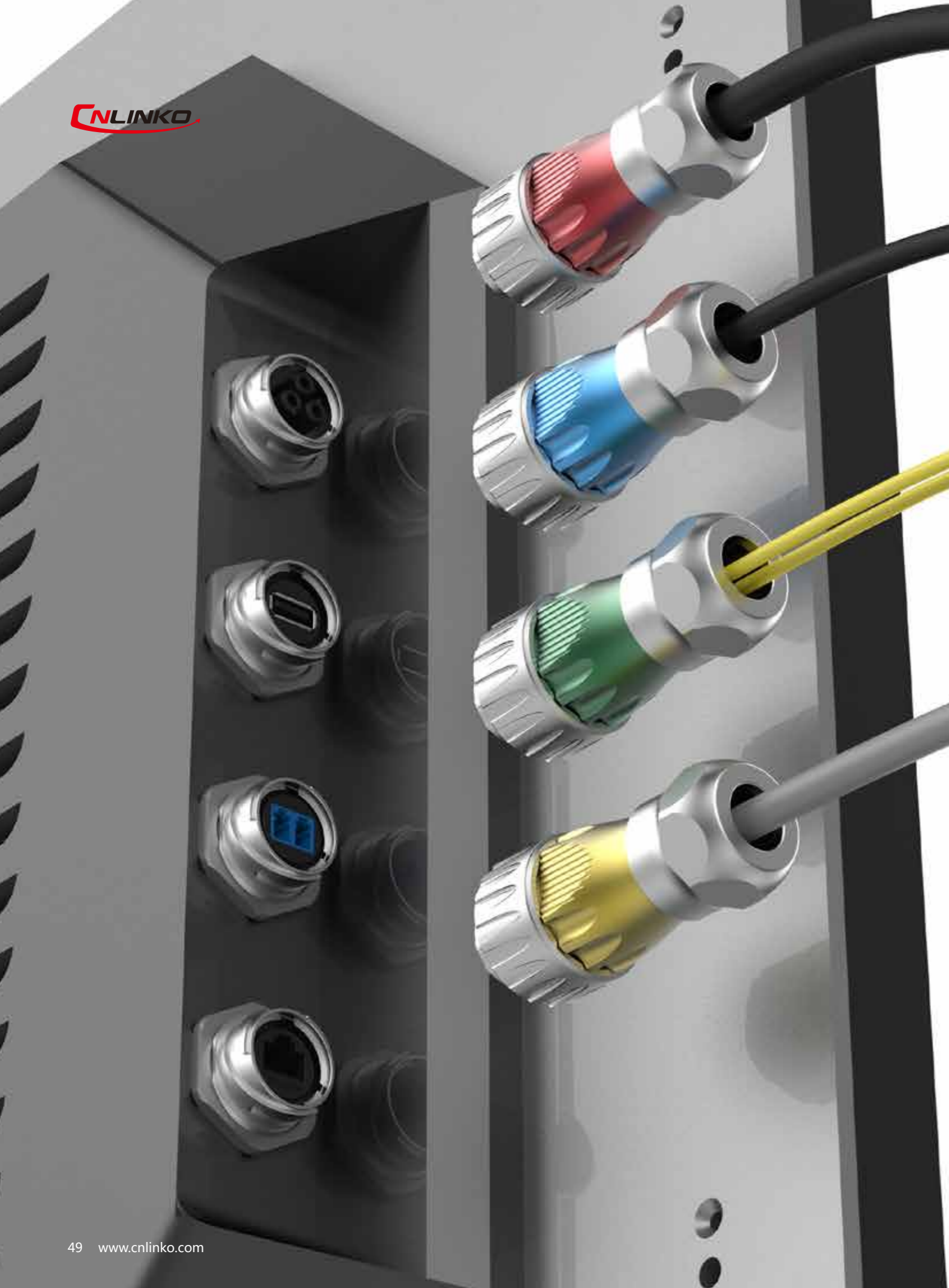

TYPE OF PRODUCT	3 PIN POWER	3 PIN POWER	4 PIN POWER
PICTURE AND PART NO.	 DH-24-C03PE-01-001 3Pins male plug(solder)	 DH-24-J03PE-01-001 3Pins Female plug(solder)	 DH-24-C04PE-01-001 4Pins male plug(solder)
	 DH-24-J03SX-01-001 3Pins Female socket(solder)	 DH-24-C03SX-01-001 3Pins Male socket (solder)	 DH-24-J04SX-01-001 4Pins Female socket (solder)

Cable specification	2.5m ² ~ 4m ² / 14 ~ 12 AWG		
Diameter range	Φ8mm ~ Φ12mm		
Contact diameter × number	3.0 x 3		3.0x4
Rated Current (A)	25A		
Operating voltage (AC.V.rms)	500V		
Contact resistance	<1mΩ		
Temperature rise	20A contact temperature below 30°C 25A.....40°CI , 30A.....50°CI.		
Withstanding Voltage (AC.V) 1 minute	2500V		
Insulation resistance	> 500MΩ		
Protection level	IP65/IP67		
Durability	> 500times		
Working temperature	-40°C ~ 80°C		
Connecting mode	Easy locking type		
Assembly wire	Soldering/Crimping		

MATERIALS

Housing&insulation parts	High-performance engineering plastics
Hardware	Zinc alloy (pearl hard chrome)
Cooper pins	Copper alloy (gold-plated 4U)
Waterproof cover	Silica gel
Flammability rating	UL94-V0

DH-24 SERIES SPECIFICATIONS SHEET

TYPE OF PRODUCT	10 PIN POWER	12 PIN POWER	19 PIN POWER	24 PIN POWER	RJ45	USB	FIBRE OPTICS
PICTURE AND PART NO.							
	DH-24-C10PE-01-001 10Pins male plug(solder)	DH-24-C12PE-01-001 12Pins male plug(solder)	DH-24-C19PE-01-001 19Pins male plug(solder)	DH-24-C24PE-01-001 24Pins male plug(solder)	DH-24-RJ45-P01 Plug	DH-24-USB3.0-P01 Plug	DH-24-F00PE-P01 Fibre optics plug
PICTURE AND PART NO.							
	DH-24-J10SX-01-001 10Pins Female socket(solder)	DH-24-J12SX-01-001 12Pins Female socket(solder)	DH-24-J19SX-01-001 19Pins Female socket(solder)	DH-24-J24SX-01-001 24Pins Female socket(solder)	DH-24-RJ45-S01 Socket	DH-24-USB3.0-S01 Socket	DH-24-F00SX-S01 Fibre optics socket

Cable specification	2.5mm ² ~ 4mm ² / 14 ~ 12 AWG				0.15mm ² ~ 0.2mm ² / 26-24 AWG		
Diameter range	Φ8mm ~ Φ12mm				Φ5.5mm ~ Φ7mm		
Contact diameter × number	3.0 x 10	3.0 x 12	3.0 x 19	3.0 x 24	8PIN	9PIN (3.0) & 4PIN (2.0)	2
Rated Current (A)	10A		5A	5A	1.5A		/
Operating voltage (AC.V.rms)	400V		250V	250V	/		/
Contact resistance	<2.5mΩ		<5mΩ	<5mΩ	<30mΩ		/
Temperature rise	10A contact temperature below 30°C 25A.....40°C↓ , 30A.....50°C↓.				/		/
Withstanding Voltage (AC.V) 1 minute	2500V		1500V	1500V	1000V		/
Insulation resistance	> 500MΩ				> 500MΩ		
Protection level	IP65/IP67				IP65/IP67		
Durability	> 500times				> 500times		
Working temperature	-40°C ~ 80°C				-40°C ~ 80°C		
Connecting mode	Easy locking type				Easy locking type		
Assembly wire	Soldering/Crimping				/		
MATERIALS							
Housing&insulation parts	High-performance engineering plastics				High-performance engineering plastics		
Hardware	Zinc alloy (pearl hard chrome)				Zinc alloy (pearl hard chrome)		
Cooper pins	Copper alloy (gold-plated 4U)				Copper alloy (gold-plated 4U)		
Waterproof cover	Silica gel				Silica gel		
Flammability rating	UL94-V0				UL94-V0		

CONNECTION SCHEMES



DIMENSION DRAWING

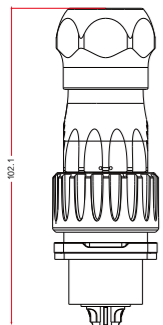

Dimensions figure

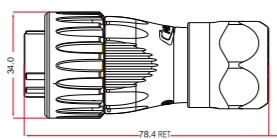

PE clamping cable plug
(dimensions figure)

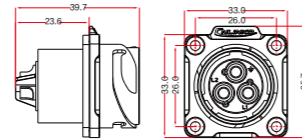

SX socket (dimensions figure)

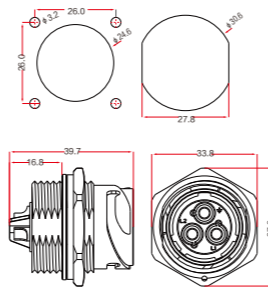

Installation hole figure